

### DETAILED PARTS AND ASSEMBLY PROCEDURE

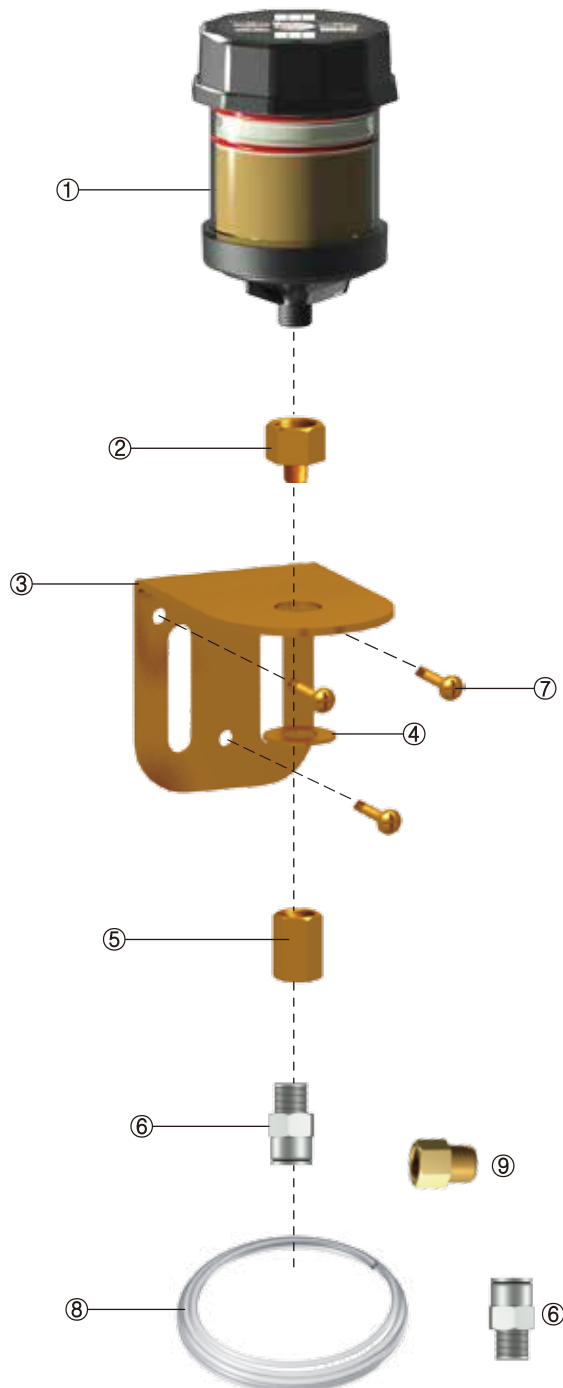

<u>LIST</u>	<u>Part No.</u>	<u>DESCRIPTION</u>	<u>Q'TY</u>
①	E120	Pulsarlube E	N/A
②	A005	PT 1/4\"F x PT 1/8\"M Adapter	1
③	B002	Mounting Bracket	1
④	B057	Steel Washer	1
⑤	A012	PT 1/8\"F x PT 1/8\"F Adapter	1
⑥	A239	PC8 – PT 1/8\"M Fitting Connector	2
⑦	B051	Self Drilling Screws	3
⑧	A212-1	5/16\"(8mm) O.D Urethane Tubing (3ft)	1
⑨	A243	Metric to inch thread converter for bearing zerk (USA only)	1

#### ASSEMBLY PROCEDURE

1. Install the mounting bracket ( ③ ) at a proper location using screws ( ⑦ ). It is good practice to mount the lubricator in close proximity to the bearing to keep feed lines as short as possible.
2. Install the lubricator ( ① ) using the provided adapter ( ② ), washer ( ④ ), and socket ( ⑤ ) on the mounting bracket ( ③ ). Be sure to position the lubricator so that it will allow for easy adjustments.
3. Insert the push-in fitting connector.
4. Measure and cut the tube ( ⑧ ) to the desired length. Be sure the tube ends are cut clean and perpendicular and that no damage is present on the outside surface.
5. Insert the tube into the push-in fitting connector ( ⑥ ) for a quick and easy leak-proof connection.
6. Program the monthly setting using the MODE button and use the provided dust cover for added protection.

#### COMMENTS

1. All Parts should be assembled tightly with PTFE tape.
2. For optimal performance with remote installation kits, using an NLGI #1 grade grease is recommended.
3. If the bearing lube point is NPT, use the thread converter ( ⑨ ).

**Note : All parts above are Metric thread.**